



HARE & FORBES

MACHINERYHOUSE

Established 1930
Distributors of New & Used Workshop Equipment

WOOD CUTTING BAND SAW

MODEL: BP-500

OPERATION MANUAL AND PARTS LIST

WOOD CUTTING BAND SAW OWNERS MANUAL

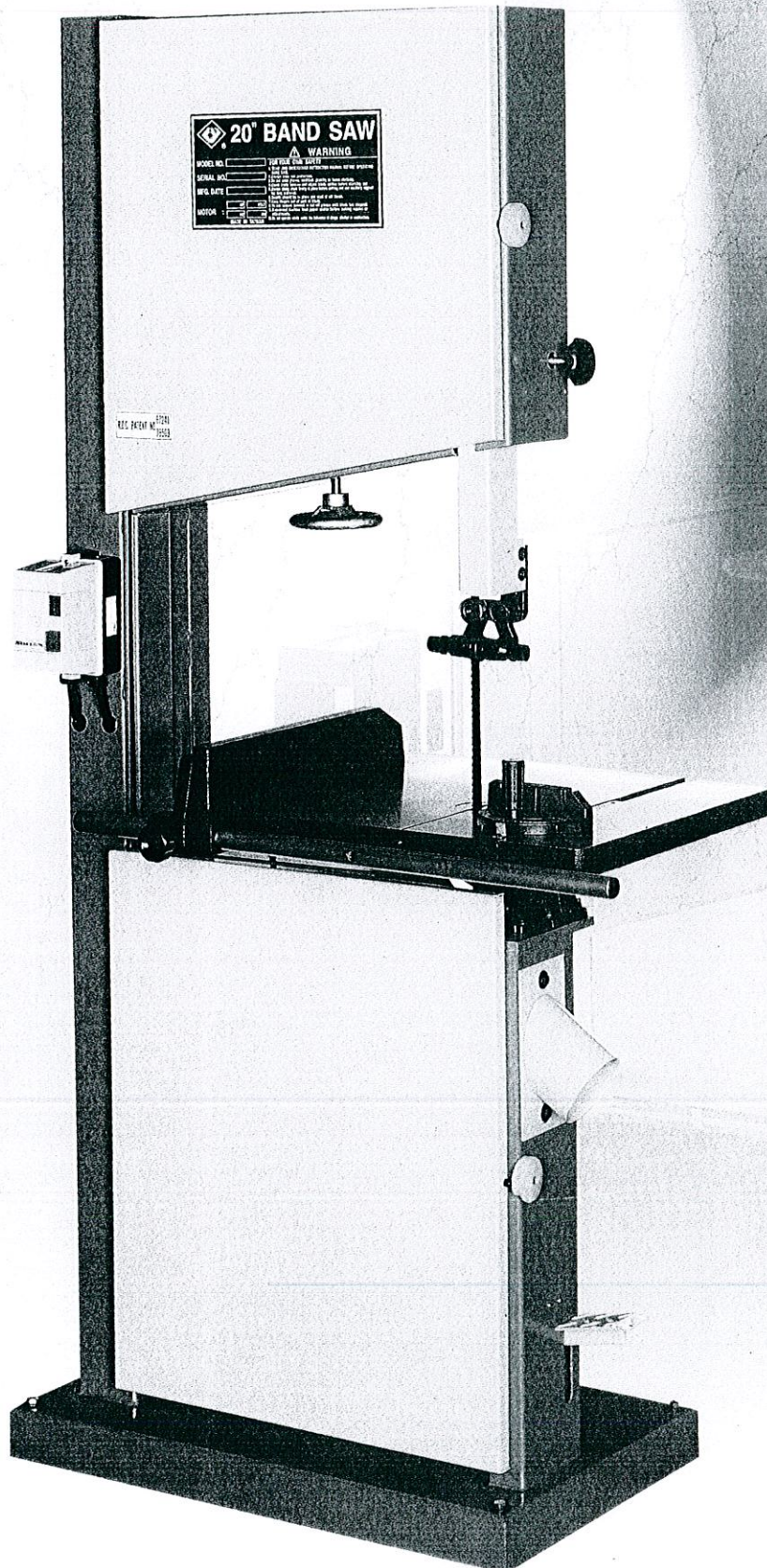



SAFETY RULES FOR ALL TOOLS:

- 1.FOR YOUR OWN SAFETY,READ INSTRUCTION MANUAL BEFORE OPERATION THE TOOL.
- 2.KEEP GUARDS IN PLACE AND IN WORKING ORDER.
- 3.GROUND ALL TOOLS.
- 4.REMOVE ADJUSTING KEYS AND WRENCHES.
- 5.KEEP WORK AREA CLEAN.
- 6.DON'T USE IN DANGEROUS ENVIRONMENT.
- 7.KEEP CHILDREN AND VISITORS AWAY.
- 8.MAKE WORKSHOP CHILDPROOF.
- 9.DON'T FORCE TOOL.
- 10.USE RIGHT TOOL.
- 11.WEAR PROPER APPAREL.
- 12.ALWAYS WEAR EYE PROTECTION.
- 13.SECURE WORK.

Use clamp or a vise to hold work when practical. It's safer than using your hand and frees both hands to operate tool.

- 14.DON'T OVERREACH.

Keep proper footing and balance at all times.

- 15.MAINTAIN TOOLS IN TOP CONDITION.
- 16.DISCONNECT TOOLS.

Before servicing and when changing accessories such as blades,bits,cutters,etc.

- 17.USE RECOMMENDED ACCESSORIES.
- 18.AVOID ACCIDENTAL STARTING.

Make sure switch is in "OFF" position before plugging in power cord.

- 19.NEVER STAND ON TOOL.
- 20.CHECK DAMAGED PARTS.
- 21.DIRECTION OF FEED.

Feed work into a blade or cutter against the direction of rotation of the blade or cutter only.

- 22.NEVER LEAVE TOOL RUNNING UNATTENDED.TURN POWER OFF.

Don't leave tool until it comes to a complete stop.

- 23.DRUGS,ALCOHOL,MEDICATION.

Do not operate tool while under the influence of drug,alcohol or any medication.

- 24.MAKE SURE TOOL IS DISCONNECTED FROM POWER SUPPLY

While motor is being mounted,connected or reconnected.

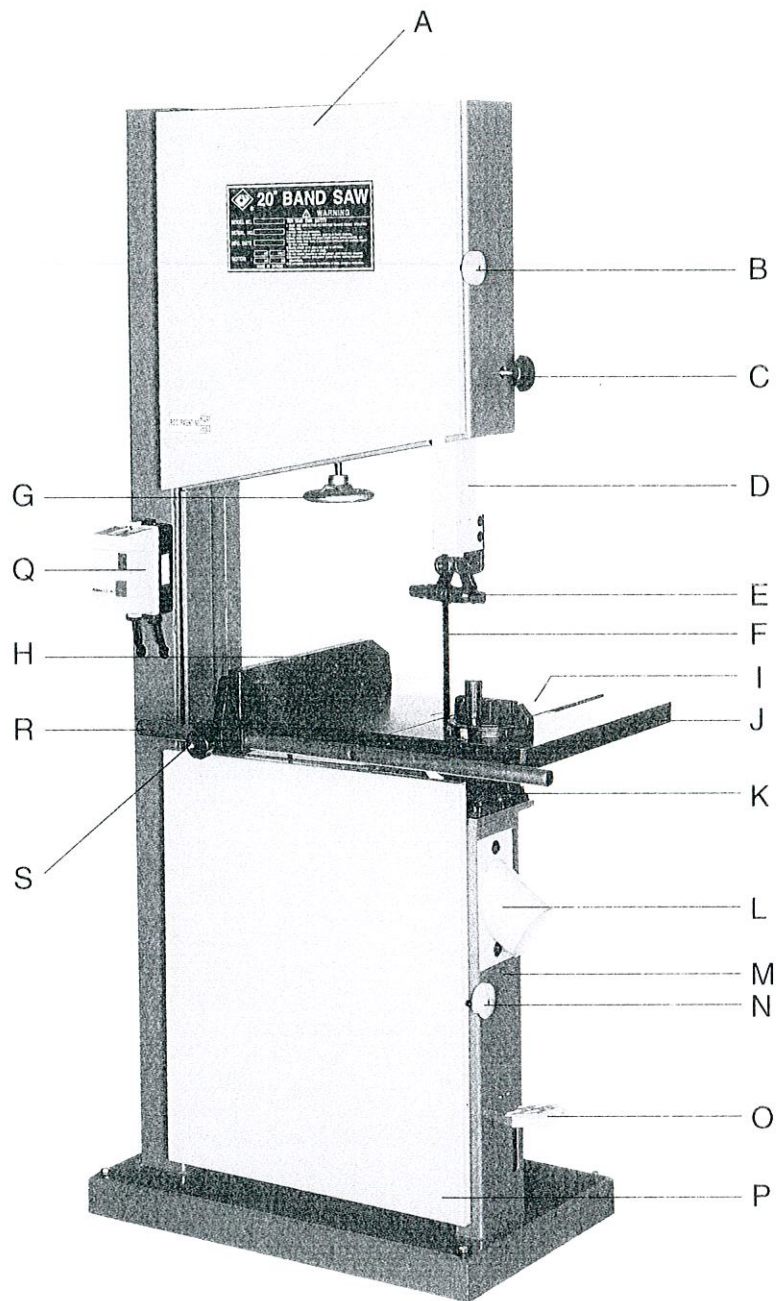

A.Upper wheel guard

B.Cross knob

C.Knob screw

D.Blade guard

E.Blade guide support (Upper)

F.Saw blade

G.Adjust wheel

H.Fence

I.Miter gage

J.Working table

K.Blade guide support (Lower)

L.Dust chute

M.Body

N.Cross knob

O.Brake pedal

P.Lower wheel guard

Q.Switch

R.Fence guided pipe

S.Fence knob



DESCRIPTION:

The bandsaw it is complete with two wheels are particularly suitable to cut wood, plastics, alloy, and can carry out longitudinal, transversal, oblique cuts and all outlining operations.

The working table has grounded cast iron (20" x 24"). It can be tilted up to 45° and includes a fence for straight cuts adjustable both on the right and on the left of the blade.

The two cast iron wheels are perfectly balanced and rubber coated.

FIG. 1(G) Adjust wheel for the upper wheel is adjustable in its height in order to enable to assemble and disassemble the blade.

Want check blade in the center, you can find the machine back, you can see have knob screw and two hex screw, knob screw its central wheel in-side or outside, and hex screw its central wheel on the right or left.

The lower wheel is provided with a little brush which maintains it always cleaned from sawdust.

The guides of blade are easily adjustable (FIG 1, E), The upper guide (lower guide) can be vertically removed. It is also provided with the appropriate safety guide.

The bandsaws are provided with all safety guards according to the safety regulations.

The machine base have four holes (730mm x 435mm), its can bracket on the land for the working.

OPERATING INSTRUCTION:

WARNING:

Before connecting the machine to the network, be sure that tension corresponds to the one indicated on the motor.

The ball bearings are self-lubricated and do not need to be oiled any longer.

The rubber coating on wheels has to be kept perfectly cleaned in order to avoid unbalances and vibrations during working operations.

Be careful that blade works with its teeth on the rubber edges in order to avoid scratches and breakings on it.

When the cutting operation is terminated, always loosen the blade otherwise it could get broken.

A correct use and maintenance of the machine will prevent it from any damage.

WOOD CUTTING BAND SAW

MACHINE ADJUSTMENT:

BLADE TENSIONING:

(FIG.1)-G. The adjust wheel allows the tensioning of the blade and its assembling and disassembling.

UPPER WHEEL ADJUSTMENT:

After machine have knob screw can adjust blade on the order.

BLADE GUIDE ADJUSTMENT:

(FIG.1)-E,K.The blade guide support has to rotate only when the blade is cutting and should have a distance of 1-2 mm from the blade back when not operating.

In order to adjust the guide support its necessary to intervene on the locking screw by means of the spanner supplied as standard.

The blade guide supports E,K have to be adjusted by means of the relative locking screw and have to maintain a distance of 0.5 mm from the blade.

The blade guide supports should never touch the blade teech.

The same written above applies for the adjustment of the lower blade guide located under the worktable.

The band saw it is provided with an upper blade guide mounting special hardened and rotating discs which allow the lateral centering.

The lateral discs have to be adjusted by means of the apposite knob and locked at the correct position of 0.5mm from the blade while the thrust disc should have a distance of 1-2mm from the blade bake side.

The upper blade guide unit can be adjusted in its height by means of the knob C. It has to be set according to the thickness of the piece being cut and maintained at a distance of 5mm from it.

A special desvice on the blade guide avoids that it goes down when loosing the knob screw,than turn the hand wheel(FIG.1) T.

WORKTABLE TILTING:

Loosen the screw nut and lock them when the table is at desired position.

RUBBER COATING REPLACEMENT ON WHEEL

Take off all rubber from the wheel with acetone. Assemble the new rubber coating and glue it to the wheel by means of bostic or similar material and turn the glued rubber in order to level the thickness and render it slightly convess.

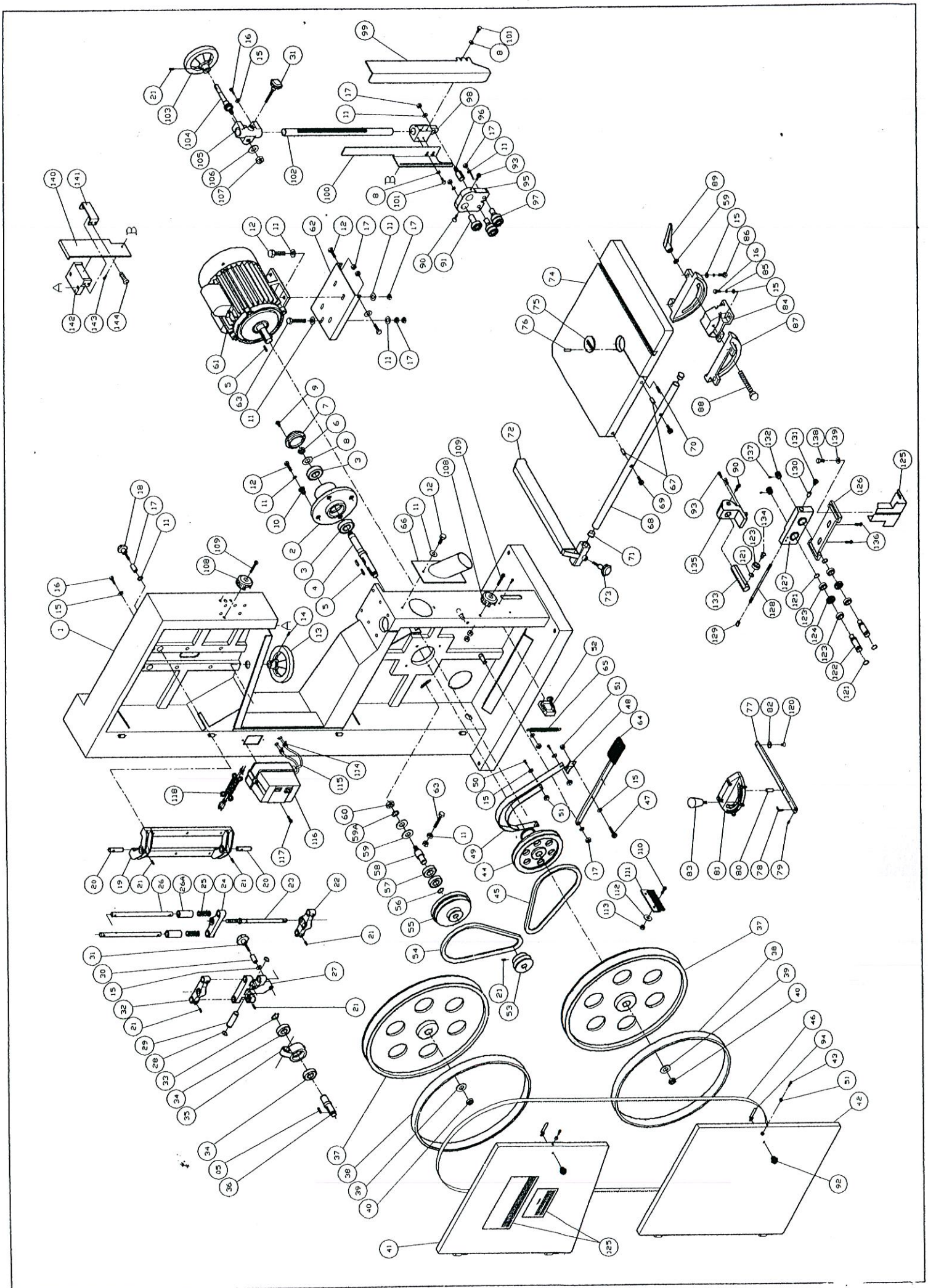

PART NO	DESCRIPTION01	Q'TY	PART NO	DESCRIPTION01	Q' TY	PART NO	DESCRIPTION01	Q'TY
01	Body	1	50	Hex Screw 1/4X5/8"	2	99	Blade Guard	1
02	Bearing Base	1	51	Hex Nut 1/4X24NC	2	100	Blade Lnter Guard	1
03	Bearing 6206ZZ	2	52	Brake Switch	1	101	Hex Screw 1/4X5/8"	2
04	Shaft	1	53	Motor Pulley	1	102	Guide Bar	1
05	Key 7X7X25	4	54	V-Belt B25	1	103	Elevator hand Wheel	1
06	Hex Nut 3/4X16NF	1	55	Intermediate Wheel	1	104	Gear	1
07	Bearing Cover	1	56	C-Ring S20	1	105	Guide bar case Bracket	1
08	Washer 3/4"	1	57	Bearing 6204ZZ	2	106	Washer	1
09	Pan Screw1/4X5/8	3	58	Intermediate Wheel Shaft	1	107	Nut 1/2"	1
10	Adjusting Screw	4	59	Washer 1/2"	2	108	Lock Knod	2
11	Spring Washer3/8"	4	60	Hex Nut 1/2"	1	109	Screw 1/4X5/8"	2
12	Hex Screw 3/8X1-1/2"	4	61	Motor	1	110	Screw3/16X1-1/2"	2
13	Adjust Wheel	1	62	Motor Mounting Plate	1	111	Bus	1
14	Set Screw5/16X3/8"	1	63	Hex Screw 3/8X2-1/2"	1	112	Washer3/16	2
15	Washer 3/8"	6	64	Brake Pedal	1	113	NUT 3/16	2
16	Hex Screw 3/8X1'	6	65	Spring	1	114	Strain Relicf	5
17	Bush	2	66	Dust Chute	1	115	Motor Cord	1
18	Lock Screw 5/16X3"	2	67	Bush	2	116	Switch	1
19	Upper Wheel Base	1	68	Guide Rail	1	117	Screw	2
20	Bracket Shaft	2	69	Cap Screw5/16X2-1/2"	2	118	Power Cord	1
21	Set Screw5/16X3/8"	4	70	Set Screw 5/16X1/2"	1	120	Screw	1
22	Adjust Bracket	1	71	Rail Cover	2	121	C-Ring	5
23	Adjust Screw	1	72	Fence	1	122	Lower Guide shaft	2
24	Elevator Bracket	1	73	Locking Knob	1	123	Ball bearing6202ZZ	5
25	Spring	2	74	Working Table	1	124	Spacer	2
26	Guide spindle	2	75	Insert	1	125	Lower Blade guard	1
27	Upper Wheel Guide Bracket	1	76	Spring Pin	2	126	Base	1
28	C-Ring S20	2	77	Miter Gage Bar	1	127	Bracket	1
29	Lever shaft	1	78	Pointer	1	128	Bolt	1
30	Bush	2	79	Pan Screw 3/16X1/4"	1	129	Threaded lock bushing	1
31	Locking Screw 3/8X3"	2	80	Pin	1	130	Lock bushing	1
32	Upper Adjust Bracket	1	81	Miter Gage	1	131	Lock knob	1
33	C-Ring S25	1	82	Guide Dise	1	132	Thumb screw	2
34	Bearing 6205ZZ	2	83	Locking Screw	1	133	Bearing support	1
35	Upper Wheel Bearing Base	1	84	Table Gage Bracket	1	134	Screw	1
36	Upper Wheel shaft	1	85	Spring Washer3/8"	4	135	Bracket	1
37	Blade Wheel	2	86	Hex Screw3/8X1-1/2"	4	136	Hex socket cap screw3/16x	2
38	Rudder Coating	2	87	Trunnion	2	137	set screw M4X4	2
39	Washer 3/4"	2	88	Locking Handle	1	138	socket head cap screw 1/4X5/8"	2
40	Hex Nut 3/4X16NF	2	89	Locking Handle	1	139	Flat washer	1
41	Upper Guard	1	90	Thumb Screw1/4X1/2	2	140	Upper blade guard	1
42	Lower Guard	1	91	Blade Support Shaft	1	141	Bracket	1
43	Hex Screw 1/4X1-1/4"	2	92	鎖	2	142	Upper guard bracked	1
44	Brake Wheel	1	93	Cap Screw1/4X5/8"	4	143	Pin	1
45	V-Belt B31	1	94	門扣	2	144	Philips screw	4
46	Blade	1	95	Upper Guide Bracket	1	145	Tracking Window	1
47	Cap screw 1/4X1-1/4"	1	96	Locking Shaft	1	146	scale	1
48	Brake Belt Locking	2	97	Guide Wheel	2	147	Lock washer 1/4	1
49	Brake Belt	1	98	Guide Bar barcket	1	148	Flat washer	1

[illegible]

WARNING

General Machinery Safety Instructions

Machinery House
requires you to read this entire Manual before using this machine.

- 1. Read the entire Manual before starting machinery.** Machinery may cause serious injury if not correctly used.
- 2. Always use correct hearing protection when operating machinery.** Machinery noise may cause permanent hearing damage.
- 3. Machinery must never be used when tired, or under the influence of drugs or alcohol.** When running machinery you must be alert at all times.
- 4. Wear correct Clothing.** At all times remove all loose clothing, necklaces, rings, jewelry, etc. Long hair must be contained in a hair net. Non-slip protective footwear must be worn.
- 5. Always wear correct respirators around fumes or dust when operating machinery.** Machinery fumes & dust can cause serious respiratory illness. Dust extractors must be used where applicable.
- 6. Always wear correct safety glasses.** When machining you must use the correct eye protection to prevent injuring your eyes.
- 7. Keep work clean and make sure you have good lighting.** Cluttered and dark shadows may cause accidents.
- 8. Personnel must be properly trained or well supervised when operating machinery.** Make sure you have clear and safe understanding of the machine you are operating.
- 9. Keep children and visitors away.** Make sure children and visitors are at a safe distance for you work area.
- 10. Keep your workshop childproof.** Use padlocks, Turn off master power switches and remove start switch keys.
- 11. Never leave machine unattended.** Turn power off and wait till machine has come to a complete stop before leaving the machine unattended.
- 12. Make a safe working environment.** Do not use machine in a damp, wet area, or where flammable or noxious fumes may exist.
- 13. Disconnect main power before service machine.** Make sure power switch is in the off position before re-connecting.
- 14. Use correct amperage extension cords.** Undersized extension cords overheat and lose power. Replace extension cords if they become damaged.
- 15. Keep machine well maintained.** Keep blades sharp and clean for best and safest performance. Follow instructions when lubricating and changing accessories.
- 16. Keep machine well guarded.** Make sure guards on machine are in place and are all working correctly.
- 17. Do not overreach.** Keep proper footing and balance at all times.
- 18. Secure workpiece.** Use clamps or a vice to hold the workpiece where practical. Keeping the workpiece secure will free up your hand to operate the machine and will protect hand from injury.
- 19. Check machine over before operating.** Check machine for damaged parts, loose bolts, Keys and wrenches left on machine and any other conditions that may effect the machines operation. Repair and replace damaged parts.
- 20. Use recommended accessories.** Refer to instruction manual or ask correct service officer when using accessories. The use of improper accessories may cause the risk of injury.
- 21. Do not force machinery.** Work at the speed and capacity at which the machine or accessory was designed.
- 22. Use correct lifting practice.** Always use the correct lifting methods when using machinery. Incorrect lifting methods can cause serious injury.
- 23. Lock mobile bases.** Make sure any mobile bases are locked before using machine.
- 24. Allergic reactions.** Certain metal shavings and cutting fluids may cause an allergic reaction in people and animals, especially when cutting as the fumes can be inhaled. Make sure you know what type of metal and cutting fluid you will be exposed to and how to avoid contamination.
- 25. Call for help.** If at any time you experience difficulties, stop the machine and call you nearest branch service department for help.



WARNING

Wood Bandsaw Safety Instructions

Machinery House
requires you to read this entire Manual before using this machine.

- 1. Maintenance.** Make sure the bandsaw is turned off and disconnect from the main power supply and make sure all moving parts have come to a complete stop before any inspection, adjustment or maintenance is carried out.
- 2. Bandsaw Condition.** Bandsaw must be maintained for a proper working condition. Never operate a bandsaw that has damaged or worn parts. Scheduled routine maintenance should be performed on a scheduled basis.
- 3. Blade Condition.** Never operate a bandsaw with a dull, cracked or badly worn blade. Before using a bandsaw inspect blades for missing teeth and cracks. Replace if required.
- 4. Replacing Blade.** Make sure teeth are face forward to the workpiece and blade is properly tensioned. Wear gloves to protect hands and wear safety glasses to protect your eyes.
- 5. Use Correct Blade.** Use the correct blade for the material being cut and the type of cut you are performing.
- 6. Hand Hazard.** Keep hands and fingers clear from the line of cut of the blade. Serious injury can occur.
- 7. Leaving a bandsaw Unattended.** Always turn the bandsaw off and make sure all moving parts have come to a complete stop before leaving the bandsaw. Do not leave bandsaw running unattended for any reason.
- 8. Avoiding Entanglement.** Blade guard must be used at all times. Remove loose clothing, belts, or jewelry items. Never wear gloves while machine is in operation. Tie up long hair and use the correct hair nets to avoid any entanglement with the bandsaw moving parts.
- 9. Understand the machines controls.** Make sure you understand the use and operation of all controls.
- 10. Power outage.** In the event of a power failure during use of the bandsaw, turn off all switches to avoid possible sudden start up once power is restored.
- 11. Work area hazards.** Keep the area around the bandsaw clean from oil, tools, chips. Pay attention to other persons in the area and know what is going on around the area to ensure unintended accidents.
- 12. Workpiece Handling.** Never hold small workpieces with your fingers during a cut. Always support/feed the workpiece with push stick, table support, vice, or some sort of clamping fixture.
- 13. Hearing protection and hazards.** Always wear hearing protection as noise generated from bandsaw blade and workpiece vibration, material handling can cause permanent hearing loss over time.
- 14. Cutting techniques.** Plan your cuts so you always cut out of the wood. Do not back the workpiece away from the blade while the saw is running. If you need to back the workpiece out, turn off the bandsaw and wait till the blade has come to a complete stop, and do not twist or put excessive stress on the blade while backing work out.
- 15. Feeding material.** Always feed material evenly and smoothly. Do not force or twist blade while cutting, especially while cutting small radii material.
- 16. Job Material.** This machine is designed to cut wood only. It is not designed to cut metal or use cutting fluid. Always inspect your material before cutting. If you have any doubt about stability or structural integrity of your stock do not cut.
- 17. Starting position/speed.** Never turn the bandsaw on when the blade is resting on the workpiece. Allow blade to reach full speed before cutting.
- 18. Guards.** Do not operate bandsaw without the blade guard in place or with the doors open.
- 19. Stopping the Blade.** Do not stop or slow the blade with your hand or workpiece. Allow the blade to stop on its own, unless the machine is equipped with a brake.
- 20. Call for help.** If at any time you experience difficulties, stop the machine and call your nearest branch service department for help.

PLANT SAFETY PROGRAM

NEW MACHINERY HAZARD IDENTIFICATION, ASSESSMENT & CONTROL

Wood Bandsaw

Developed in Co-operation Between A.W.I.S.A and Australia Chamber of Manufactures
This program is based upon the Australian Worksafe Standard for Plant(NOHSC:1010-1994)

Item No.	Hazard Identification	Hazard Assessment	Risk Control Strategies (Recommended for Purchase / Buyer / User)
A	ENTANGLEMENT	HIGH	Eliminate, avoid loose clothing / Long hair etc.
B	CRUSHING	LOW	Ensure bandsaw is on level ground to and safe place to prevent it falling.
C	CUTTING, STABBING, PUNCTURING	MEDIUM	Blade guards should always be in the closed position before starting machine. Top blade guide system should be adjusted to suit material thickness. Isolate main power switch before changing blade, cleaning or adjusting. Use a push stick to remove off-cuts. Hands must always be kept well away from blade at all times. Check blade tracking before starting.
D	SHEARING	MEDIUM	Make sure all guards are secured shut when machine is on.
F	STRIKING	LOW	Support long heavy work pieces. Remove all loose objects around moving parts. Wear safety glasses
H	ELECTRICAL	MEDIUM	Should blade break turn off machine immediately and use foot brake to stop if supplied. All electrical enclosures should only be opened with a tool that is not to be kept with the machine.
O	OTHER HAZARDS, NOISE, DUST.	LOW	Wear hearing protection as required. Must be connected to dust extraction.

Plant Safety Program to be read in conjunction with manufactures instructions

HARE & FORBES
MACHINERYHOUSE

www.machineryhouse.com.au

MACHINERYHOUSE

www.machineryhouse.co.nz

Authorised and signed by:
Safety officer:

Manager:

Revised Date: Aug-08